

### Applications

Comepi foot switches of the MP series are plastic foot switches in mini design that besides their robust form and technical versatility are specially convincing for their functionality and ergonomic design. They can be applied on foot switch operated machines such as: shearing machines, spinning lathers, machine tools, wrapping machines, riveting presses, etc.

### Description of MP6... Mini Foot Switches

- **Dimensions:** 100 x 75 x 34 mm.
- **Materials:** cover and base made of self-extinguishing ABS.
- **Colour choice:** black or grey base; black, grey, yellow or red cover.

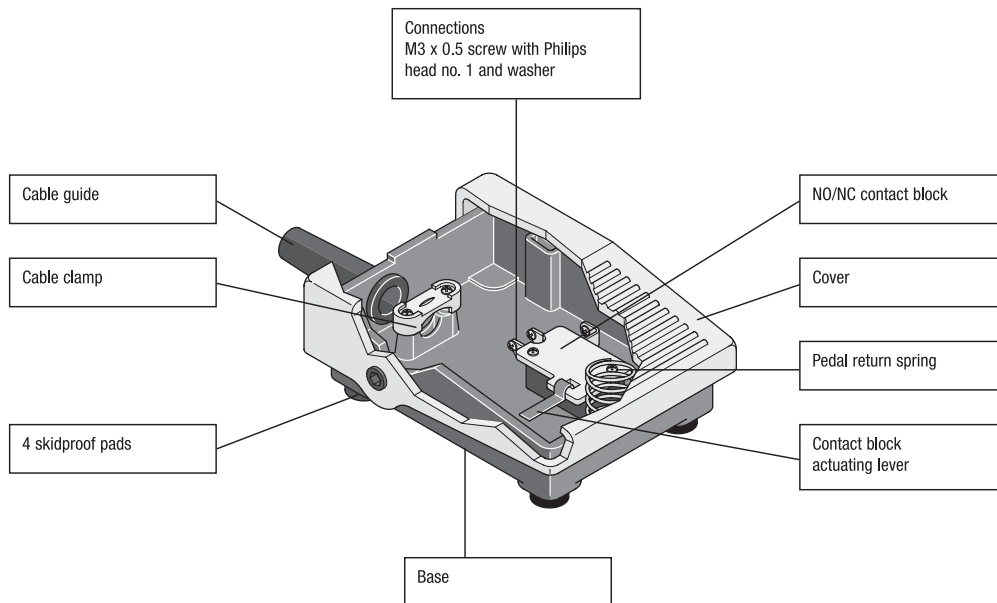

### Symbols

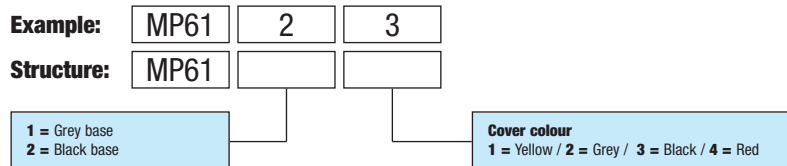

### Dimensions (in mm)

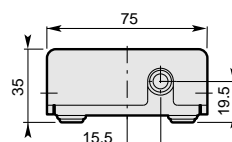
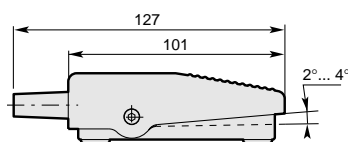

### NO / NC Contact Block

